

SHEET A  
SHEET C

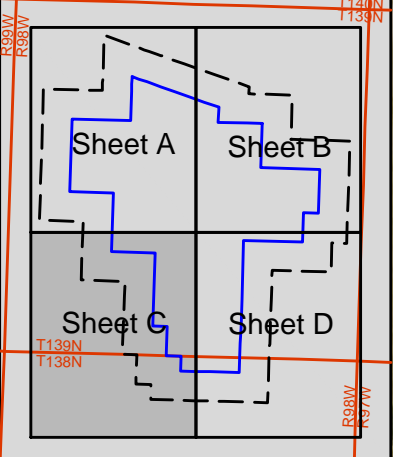

30

29

28

31

32

33

R98W  
T139N  
T138N

6

5

4

7

8

SHEET C  
SHEET D

**REFERENCES**  
Study Area: Golder, 10/18/2007.  
Permit Boundary: IEI, 11/10/2009.  
PLSS: ND HUB, 6/20/2006.  
Aerials: Golder 06/19/2006 & Stark Co. NAIP 2004  
Projection: StatePlane, North Dakota South, NAD27, Feet.

MAP UNIT		HABITAT LEGEND	
MAP UNIT	TYPE	MAP UNIT	TYPE
001	Rock Outcrop	310	Mesic Shrub Drainage
002	Stream/Pond/Impoundment	410	Native Grassland
021	Rural Building Site	413	Riparian Grassland
022	Shelterbelt	510	Alfalfa (hayed)
023	Road/ROW/Utilities	520	Crop
110	Deciduous Streambank	530	Tame Pasture/CRP
222	Silver Sagebrush		

**LEGEND**  
— Primary Study Area  
— Secondary Study Area  
— Permit Boundary  
— Wildlife Habitat Boundary  
— Section

500 250 0 500  
SCALE 1"=500'  
IF PRINTED AT 34 IN. X 44 IN.

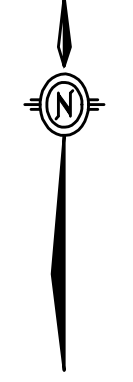

SOUTH HEART COAL LLC SOUTH HEART LIGHTS MINE STARK COUNTY, NORTH DAKOTA	
FISH & WILDLIFE HABITAT MAP SHEET 3 OF 4	
WESTECH Environmental Services	Exhibit 2.9-1C