

SHEET A
SHEET C

SHEET B
SHEET C

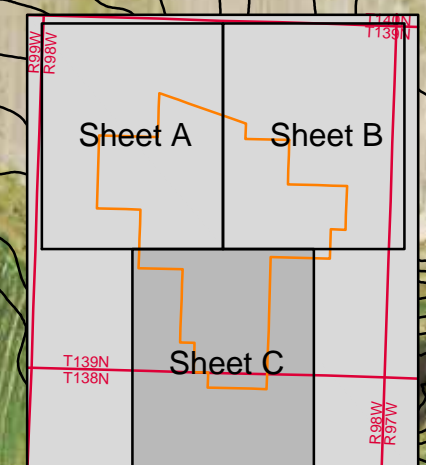

CLASSIFICATION LEGEND

HYDROGEOMORPHIC CLASS			
R	Riverine	Other	
R2	Lower Perennial	UB3 - Unconsolidated Bottom - Mud	
R4	Nonperennial	PI - Potentially Isolated	
D	Depressional	UPL - Upland	
MF	Mineral Flat		
S	Slope		
COWARDIN MODIFIERS			
Vegetation Type		Special Modifiers	
EM	Emergent (Herbaceous)	b	Beaver
SS	Scrub/Shrub	h	Diked/Impounded
FO	Forested	x	Excavated
OW	Open Water		
Water Regime			
A	Temporary		
B	Saturated		
C	Seasonal		
F	Semipermanent		

NOTE: Potentially isolated wetlands are mapped but may be determined by the U.S. Army Corps of Engineers to be non-jurisdictional because of isolation or lack of a significant nexus.

AERIAL PHOTO: 06/19/2006
STATE PLANE, NORTH DAKOTA
SOUTH (3300) NAD27, FEET

REFERENCES

Study Area: Golder, 10/18/2007.
Permit Boundary: IEL, 11/12/2009.
Disturbance Boundary: Norwest, 9/16/2010.
Township, Range and Section: ND HUB, 6/20/2006.
Projection: StatePlane, North Dakota South, NAD27, Feet.

LEGEND

- Study Area
- Permit Boundary
- Disturbance Boundary
- Wetland plot
- SHSS-17 Water Quality Sampling Location (approximate)
- Wetland Boundary
- Township and Range
- Section
- Index Contour - 5 ft Interval
- Contour - 20 ft Interval

SCALE 1"=500'
IF PRINTED AT 34 IN. X 44 IN.

DATE	BY	REVISION	DATE	BY	REVISION
WETLAND MAP SHEET 3 OF 3					
EXHIBIT 1C					